



**syntech**  
POWER & LIGHT

# INSTALLATION MANUEL

## **MODULA SERIES**

### **SURFACEMOUNT LED EXIT SIGN**



PLEASE READ THIS MANUEL CAREFULLY **PRIOR TO INSTALLATION.** RETAIN A COPY  
AT ALL TIMES FOR FUTURE REFERENCE

**SYNTECH MODEL NUMBER(S)**

SYN-0303-LES-SM

## INSTALLATION MANUEL - EDGE-LITE Series – Surface Mount LED Exit Sign

Remove the product from the box and inspect it for any damage. If you believe the product to be damaged or otherwise unsound, DO NOT install the product. Please pack it back into its box and return it to the place of purchase for replacement. If the product is satisfactory, proceed with the installation.

### INSTALLATION

Remove the cover using a flat blade screwdriver, release the clip by pushing in and down. The top cover can then be removed by sliding it away from the screwdriver. The cover **MUST BE** mounted prior to attaching to the body.

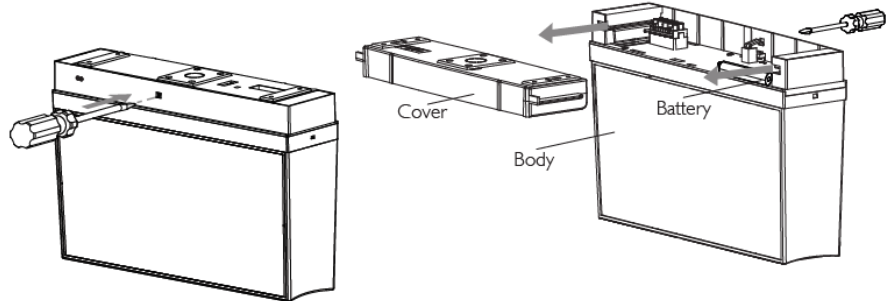

### MOUNTING

Mount cover and connect wiring to terminals.

Assemble the product by sliding the body into place

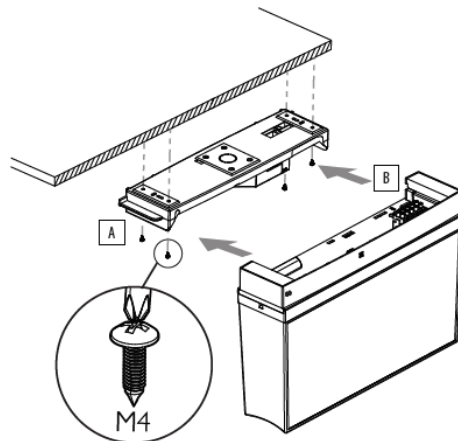

### NON-MAINTAINED / MAINTAINED

#### MAINTAINED

LED is ON in normal and emergency operation

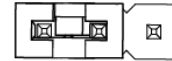

#### NON-MAINTAINED

LED is only ON in emergency

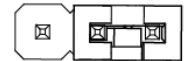

### TERMINAL BLOCK

Wiring schematic for the terminal block used with the Mercury Basic.

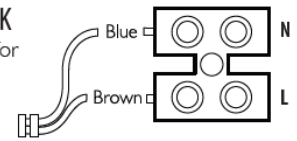

### REPLACING THE BATTERY

Access the battery by removing the product cover. Disconnect and remove battery. Replace battery as was previously installed. Battery can be connected in one direction only, do not force. Allow a minimum 24 hours charging time before carrying out any discharge tests as per the requirements in AS/NZS 2293.

### WARNING

The CR-7040 Emergency Luminaire is connected to an unswitched active during normal operating conditions. When disconnected from the mains supply, the CR-7040 is powered by a Lithium-ion battery operated inverter. Due to this, care should be taken when replacing the battery.

### SAFETY WARNINGS

1. THIS PRODUCT MUST ONLY BE INSTALLED BY A LICENSED ELECTRICIAN.
2. BEFORE COMMENCING INSTALLATION TURN OFF AND ISOLATE THE ELECTRICAL SUPPLY.
3. RISK OF ACCIDENTAL CONTACT WITH LIVE PARTS. DO NOT ENERGISE WITH PRODUCT OPEN OR DISASSEMBLED.
4. SUPPLY VOLTAGES WITHIN PRODUCT. ISOLATE SUPPLY VOLTAGES BEFORE OPENING OR SERVICING.
5. THIS LUMINAIRE IS NOT INTENDED FOR USE IN HIGH-RISK TASK AREA LIGHTING.
6. MAINS SUPPLY AND BATTERY CIRCUIT SEPARATED BY REINFORCED INSULATION.
7. THE ONLY USER SERVICEABLE / REPLACEABLE PART IS THE BATTERY PACK.
8. DO NOT ATTEMPT TO SERVICE OTHER PARTS OF THE FITTING AS THIS WILL VOID THE WARRANTY.
9. AS THE INSTALLER, IT IS YOUR RESPONSIBILITY TO ENSURE YOU COMPLY TO ALL RELEVANT BUILDING AND SAFETY CODES FOR EXAMPLE THE BCA, AS3000. REFER TO APPLICATION STANDARDS FOR THE RELEVANT RULES.

## BATTERY LIFE

To maintain the economic life of this product it is required that the battery be discharged and recharged at least once every 6 months. The battery life can be reduced if the battery is not discharged as per the requirements of AS/NZS 2293 or an equivalent standard. Increasing the number of duration tests above that as defined in AS/NZS 2293 or an equivalent standard can have a positive effect on the battery performance as long as 12 discharge cycles per year is not exceeded. The recharging device will operate normally after removal of short circuit fault.

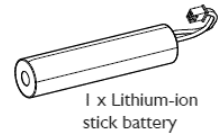

## DIMENSIONS

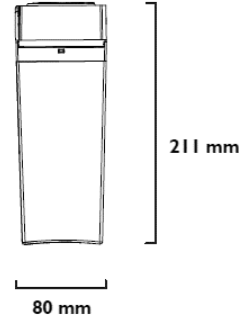

<b>Voltage (V)</b>	230 V	<b>Mounting Type</b>	Rod / surface / suspended or wall mounted
<b>Frequency (Hz)</b>	50 Hz	<b>Wiring</b>	Terminal block (1 - 16mm □)
<b>Ambient Temp. (°C)</b>	0 - 40°C	<b>Viewing Distance</b>	24M
<b>Class</b>	2	<b>Battery Type</b>	3.7V Lithium-ion battery
<b>Duration</b>	120 min	<b>Battery Supply Current</b>	600mA
<b>IP Rating</b>	IP20	<b>Charging Time</b>	24 hours
<b>Emergency Classification</b>	C0:E2 C90:E1.6 (2Hr)	<b>Charger Type</b>	Variable
<b>Average Power Consumption</b>	2.2 W (Maintained)	<b>Max Power Consumption</b>	3.5 W (Maintained)

Note: Syntech International strongly recommends this product be installed by a licensed electrician